

Protecting your water system over the winter period



The winterisation procedure below refers to the water heating system installed in all Groundhog units **BEFORE JULY 2013**.

Allowing water to freeze in the system of your groundhog unit may result in damage to the water pump and water heating system.

To help prevent this from happening it is advised you follow the following procedures when unit is not being used over night, or left for long periods without use.

Step 1



Remove blue fresh water pipe from the water container below the sink.

Step 2



Turn power selector switch, situated under the consumer unit to position 3.

Step 3



Switch off handwash main isolator switch, situated above the handwash touch button.

Step 4



Push handwash touch button, situated next to heat adjuster and leave to run until all the water has been pumped out of the system. This should take approximately 20-30 seconds.

Step 5



Switch off pump isolator switch, situated below the sink.

Step 6



Drain both fresh and waste water containers.

To bring water system out of winterised mode

Before operating the Handwash:

1. Check the Power Selector switch (situated below the main distribution board) is set to the '2 Handwash' position.
2. Insert blue fresh water pipe into the water container below the sink.
3. Check the fresh water container is full
4. Switch on Pump isolator switch (situated below the sink).

To operate the Handwash:

1. Turn on the 'Handwash Main Isolator'
2. Press Handwash Touch button



*Request the **new Operators Instruction Manual** which includes the winterisation preparation guide.

Please visit groundhog.co.uk to request your copy.

If you require further information on the safe use of Support Stands, please contact **groundhog** on:

TEL: **01639 641166** | EMAIL: sales@groundhog.co.uk | www.groundhog.co.uk

Groundhog Ltd, Ynysgerwn Avenue, Aberdulais, Neath, SA10 8HH



Protecting your water system over the winter period



The winterisation procedure below refers to the water heating system installed in all Groundhog units **BETWEEN JULY 2013**

Allowing water to freeze in the system of your groundhog unit may result in damage to the water pump and water heating system.

To help prevent this from happening it is advised you follow the following procedures when unit is not being used over night, or left for long periods without use.



Step 1

Remove blue fresh water pipe from the water container below the sink.



Step 2

Turn power selector switch, situated under the consumer unit to position 2.



Step 3

Push handwash touch button, situated next to heat adjuster and leave to run until all the water has been pumped out of the system. This should take approximately 20-30 seconds.



Step 4

Switch off handwash main isolator switch, situated above the handwash touch button.



Step 5

Switch off pump isolator switch, situated below the sink.



Step 6

Drain both fresh and waste water containers.

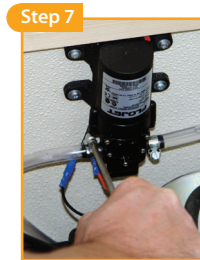

Step 7

Loosen jubilee clip from left hand side of water pump. Pump is located under doorside seat bench in canteen.

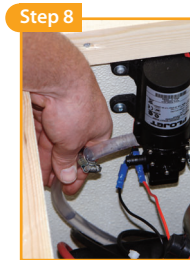

Step 8

Remove pipe from water pump.



Step 9

Turn power selector switch, situated under the consumer unit to position 3.



Step 10

In toilet area, swipe hand over Autowash sensor to empty remaining water in the system. The pump will run for approximately 20 seconds. This process may have to be repeated.



Step 11

Disconnect the 12 Volt neutral cable (black).

To bring water system out of winterised mode

Before operating the Handwash:

1. Check the Power Selector switch (situated below the main distribution board) is set to the '2 Handwash' position.
2. Insert blue fresh water pipe into the water container below the sink.
3. Check the fresh water container is full
4. Switch on Pump isolator switch (situated below the sink).

To operate the Handwash:

1. Turn on the 'Handwash Main Isolator'
2. Press Handwash Touch button



*Request the **new Operators Instruction Manual** which includes the winterisation preparation guide.

Please visit groundhog.co.uk to request your copy.

If you require further information on the safe use of Support Stands, please contact **groundhog** on:

TEL: **01639 641166** | EMAIL: sales@groundhog.co.uk | www.groundhog.co.uk

Groundhog Ltd, Ynysgerwn Avenue, Aberdulais, Neath, SA10 8HH



Protecting your water system over the winter period



The winterisation procedure below refers to the water heating system installed in all Groundhog units **AFTER AUGUST 2014**.

Allowing water to freeze in the system of your groundhog unit may result in damage to the water pump and water heating system.

To help prevent this from happening it is advised you follow the following procedures when unit is not being used over night, or left for long periods without use.

Step 1



Remove blue fresh water pipe from the water container below the sink.

Step 2



Canteen area

Push hand wash touch button, situated above sink and leave to run until all the water has been pumped out of the system. This should take approximately 20-30 seconds.

Step 3



Toilet area

Push hand wash touch button, situated to the left of the towel dispenser in the toilet and leave to run until all the water has been pumped out of the system. This should take approximately 20-30 seconds.

Step 4



Drain both fresh and waste water containers.

To bring water system out of winterised mode

Before operating the Warm Water System:

1. Check the fresh water container is full.
2. Insert blue fresh water pipe into the water container below the sink.

To operate the Handwash on the canteen or toilet area press the touch button.
This will provide at least 10 seconds of warm water.
(For cold water, operate the foot pump in the toilet.)



*Request the **new Operators Instruction Manual** which includes the winterisation preparation guide.

Please visit groundhog.co.uk to request your copy.

If you require further information on the safe use of Support Stands, please contact **groundhog** on:

TEL: **01639 641166** | EMAIL: sales@groundhog.co.uk | www.groundhog.co.uk

Groundhog Ltd, Ynysgerwn Avenue, Aberdulais, Neath, SA10 8HH

